

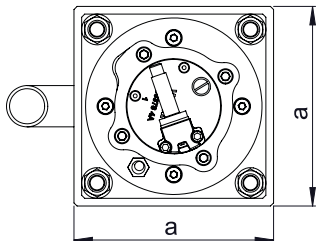

# PG - Air blasts

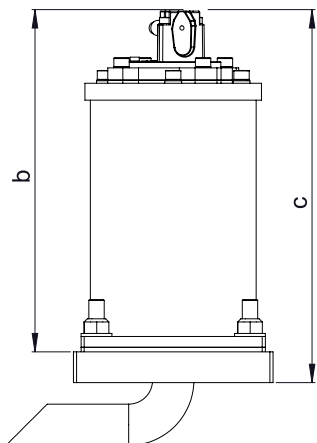

DIMENSIONAL SPECIFICATIONS

MODEL	AIR CONSUMPTION (NL)		I Ø PIPE mm	AIR INLET BSPP	A	B	C	WEIGHT
	3 bar	6 bar			mm	mm	mm	Kg
PG 40	3.6	5.3	6	1/8" BSPP	130	220	243	6.8
PG 63	6.4	11.6	8	1/4" BSPP	160	260	283	13.0
PG 80	12.5	21.0	8	1/4" BSPP	200	308	336	22.5

## PG - AIR BLASTS

APPLICATION	Hopper and silo
POWDER	Large size, irregular shape, fibrous dust and flakes
PROBLEM SOLVING	Bridge and rat-holing

## FEATURES

DUTY CYCLE	Discontinuous
WORKING PRESSURE	From 3 bar to 6 bar (from 43 psi to 87 psi)
PNEUMATIC CIRCUIT	Filter + flow control valve
AIR SUPPLY QUALITY	Class 5.4.1.
WORKING TEMPERATURE	From -20 °C to 80 °C (from -4 °F to 176 °F)
MAX NOISE LEVEL	105 dB (a)
TECHNOLOGY	High pressure jet
MATERIAL	Steel body and plate, PS040-063 nylon (PS080 aluminium) head

## OPTIONS

TIMER	Adjustable from 30sec to 45min
MULTI-TENSION COILS	From 24v (Ac/Dc) to 230v
FULLY PNEUMATIC KIT	Available

This information is furnished without warranty, representation, inducement or license of any kind. It is accurate to the best OLI knowledge or is obtained from sources believed to be accurate. OLI therefore assumes no legal responsibility.

